

Nomadic  **Display**®
www.nomadicdisplay.com

Europe: Tel: 353/98 66900 • NorthAmerica: Tel: 800/336 5019

Assembly Instructions Notes -

- Step .1** - Read the general assembly instructions below to understand the basic assembly of the stand.
- Step .2** - Locate panel **A1** in the packing cases and begin assembly from the starting point. Each of the components are individually numbered and has a drawing that explains it's location and installation.
- Step .3** - Follow the numbering sequence to complete each section of the stand.

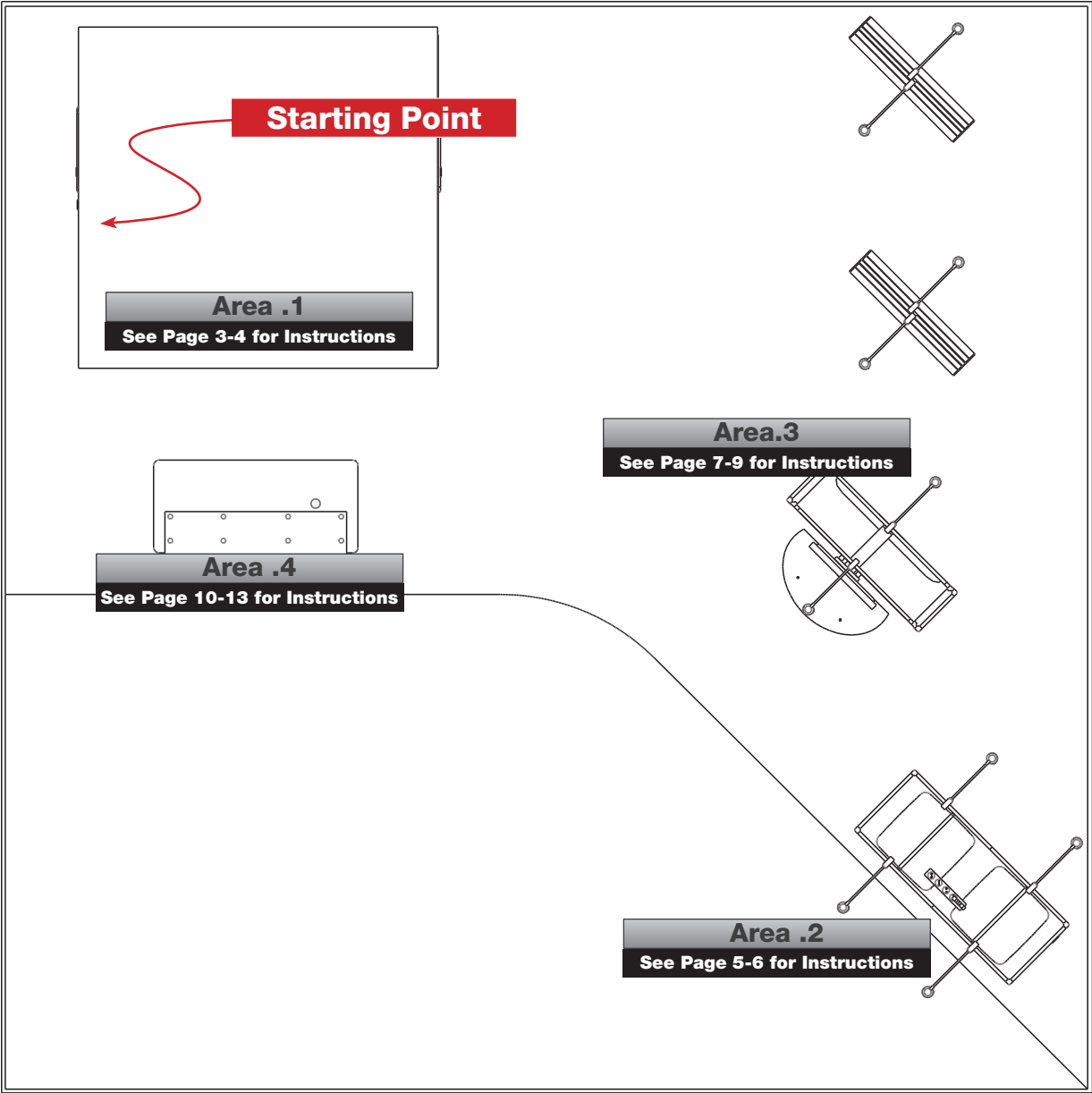

Platinum General Assembly Instructions

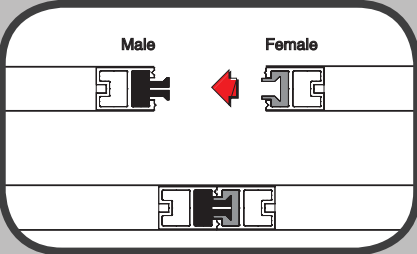

All panels have male and female connectors. The male connector should always be on your right when facing the front of the display.

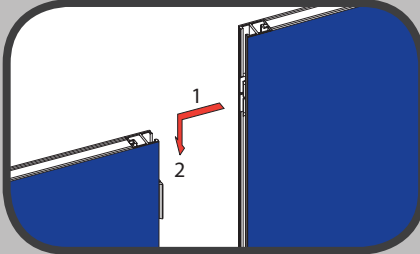

Align the panels and slide the female connectors down over the male connectors.

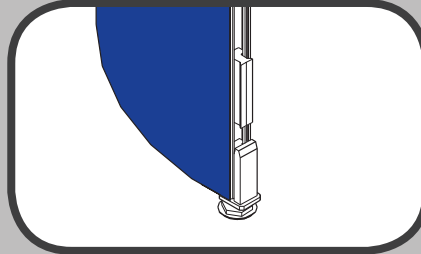

The base level has adjustable feet that allow you to level the display on an uneven floor. You should assemble the entire base level before adjusting feet.

DesignLine General Assembly Instructions



Steel baseplates are secured to the columns by a threaded connecting block that is fixed to the inside track of the columns. An M8 screw is used to fix the Baseplates to the connecting block.



The DesignLine Vertical columns are fixed together by a connecting block that is inserted into the inside track of the columns. The columns are then braced with two vertical connectors.

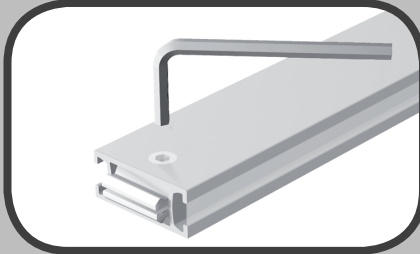

The DesignLine horizontal extrusions lock into the channels in the columns. An allen wrench is used to spread the lock inside the channel to secure the horizontal extrusion in place.

Assembly Instructions Notes -

Step .1 Locate Base Plate **A1** in the packing cases and begin assembly from the starting point. Each of the components are individually numbered and has a drawing that explains it's location and installation.

Step .2 Follow the numbering sequence to complete **Area 1**.

Area 1 - Plan View



Area 1 - Perspective View

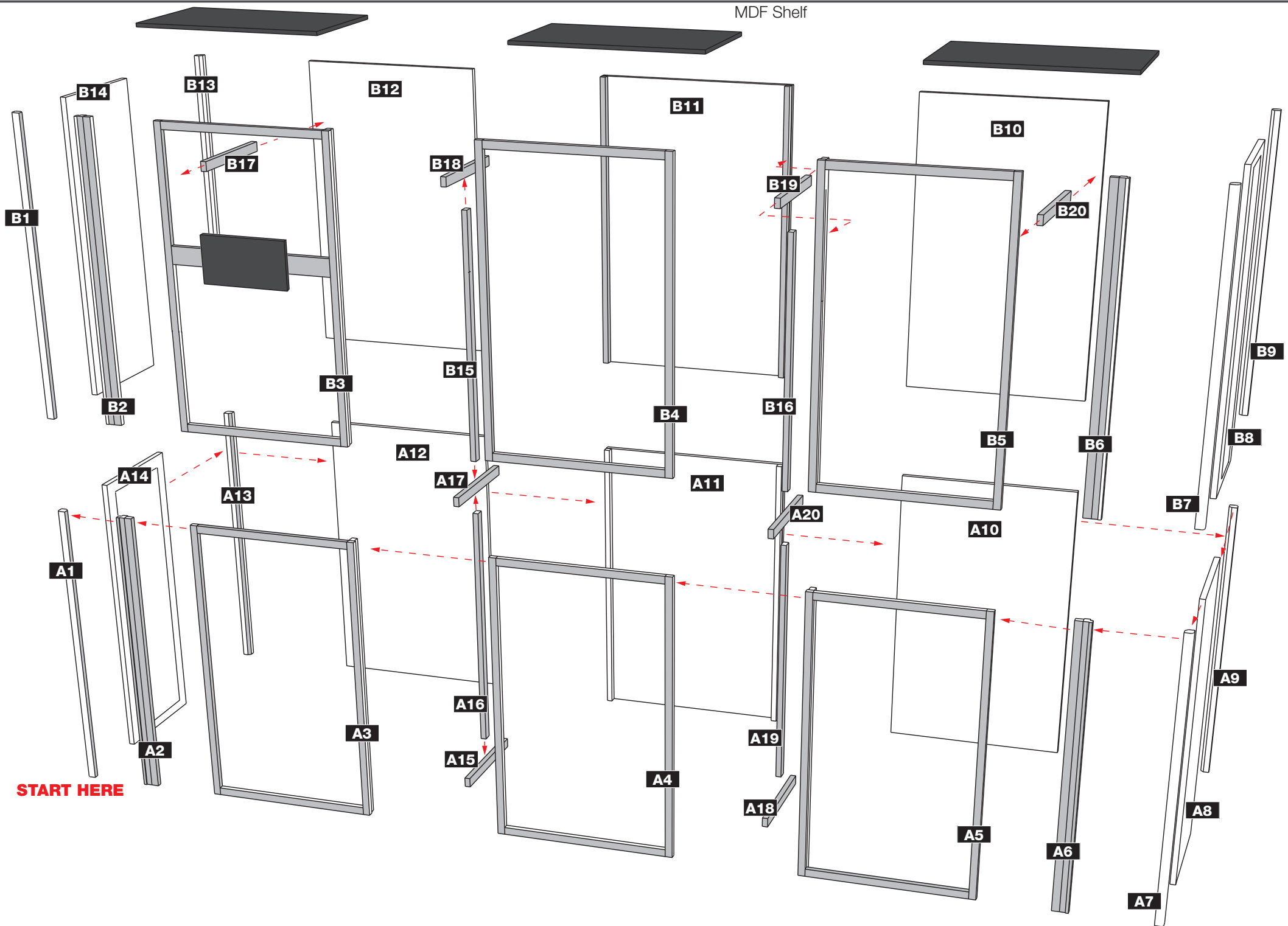

Part Description

A1	1000mmH Interconnector - 90 Deg Round
A2	1000mmH Interconnector Platinum / Graphic with endcap
A3	601mmW x 1000mmH - Flat Custom Bareframe
A4	630mmW x 1000mmH - Flat standard Bareframe
A5	601mmW x 1000mmH - Flat Custom Bareframe
A6	1000mmH Interconnector Platinum / Graphic with endcap
A7	1000mmH Interconnector - 90 Deg Round
A8	413mmW x 1000mmH - Flat Standard
A9	1000mmH Interconnector - 90 Deg Round
A10	630mmW x 1000mmH - Flat standard
A11	682mmW x 1000mmH - Flat custom
A12	630mmW x 1000mmH - Flat standard
A13	1000mmH Interconnector - 90 Deg Round
A14	413mmW x 1000mmH - Flat Standard cabinet door
A15	378mmL - DesignLine Flat Horizontal - 70mm Standard
A16	820mmL - DesignLine Flat Horizontal - 70mm Standard
A17	378mmL - DesignLine Flat Horizontal - 70mm Standard
A18	378mmL - DesignLine Flat Horizontal - 70mm Standard
A19	820mmL - DesignLine Flat Horizontal - 70mm Standard
A20	378mmL - DesignLine Flat Horizontal - 70mm Standard

B1	1000mmH Interconnector - 90 Deg Round
B2	1000mmH Interconnector Platinum / Graphic with endcap
B3	601mmW x 1000mmH - Flat Custom Bareframe
B4	630mmW x 1000mmH - Flat standard Bareframe
B5	601mmW x 1000mmH - Flat Custom Bareframe
B6	1000mmH Interconnector Platinum / Graphic with endcap
B7	1000mmH Interconnector - 90 Deg Round
B8	413mmW x 1000mmH - Flat Standard cabinet door
B9	1000mmH Interconnector - 90 Deg Round
B10	630mmW x 1000mmH - Flat standard
B11	682mmW x 1000mmH - Flat custom
B12	630mmW x 1000mmH - Flat standard
B13	1000mmH Interconnector - 90 Deg Round
B14	413mmW x 1000mmH - Flat Standard
B15	820mmL - DesignLine Flat Horizontal - 70mm Standard
B16	820mmL - DesignLine Flat Horizontal - 70mm Standard
B17	378mmL - DesignLine Flat Horizontal - 70mm Standard
B18	378mmL - DesignLine Flat Horizontal - 70mm Standard
B19	378mmL - DesignLine Flat Horizontal - 70mm Standard
B20	378mmL - DesignLine Flat Horizontal - 70mm Standard

Assembly Notes

- Step .1** Assemble the panels starting with **(A1)**. Slide the panels together by following the numbering sequence ending with **(B14)**.
- Step .2** Place MDF shelves on horizontal extrusions B17 - B20

Assembly Detail .1



Assembly Detail .2

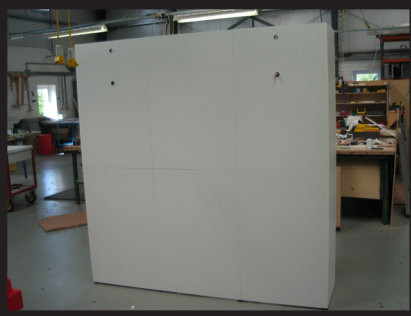

Assembly Detail .3



To attach screen mount Slide connectors of the mount into the channels on the panel (B3) and lock in position It can also be connected to panel (B5)

Plan View



Assembly Instructions Notes -

Step .1 Locate Base Plate **A21** in the packing cases and begin assembly from the starting point. Each of the components are individually numbered and has a drawing that explains it's location and installation.

Step .2 Follow the numbering sequence to complete **Area 2**.

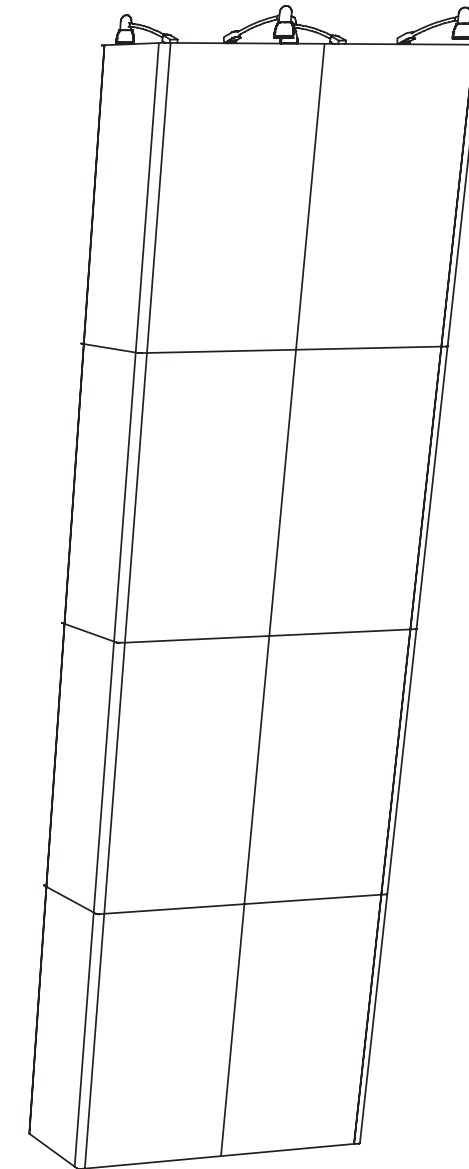

Area 2 - Perspective View

Area 2 - Plan View

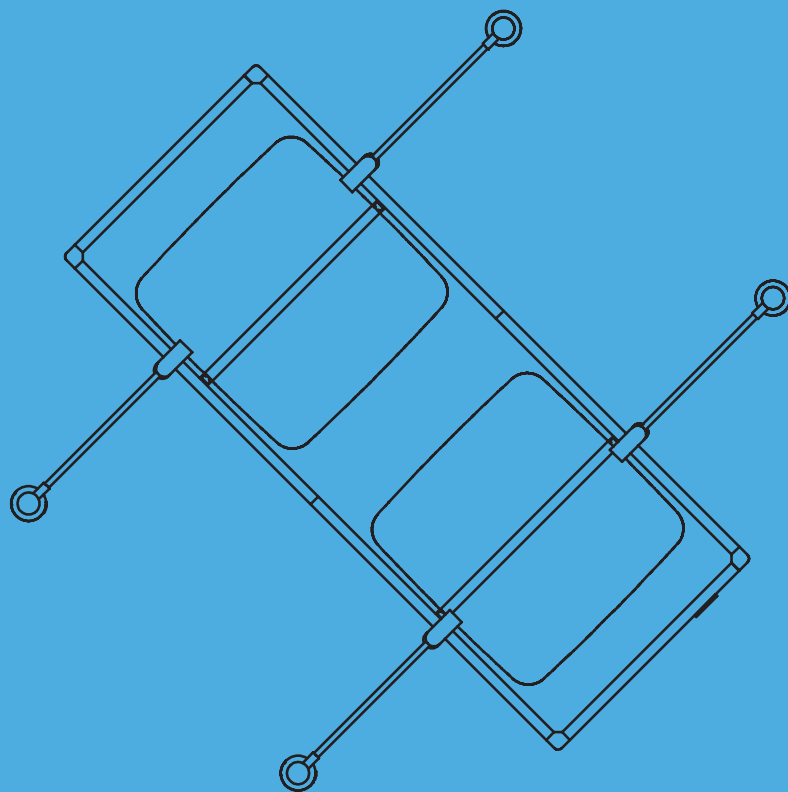

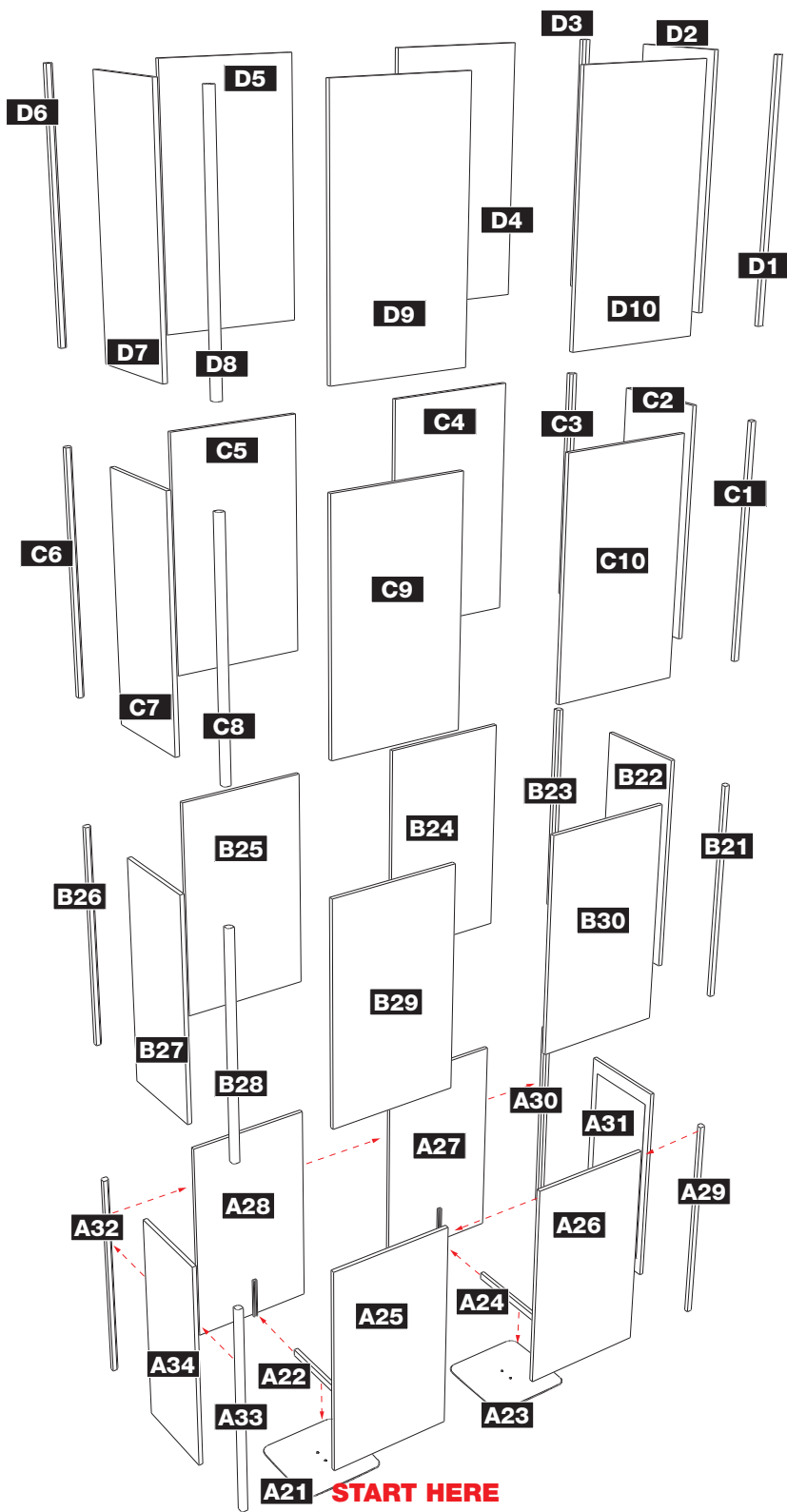

Part Description

A21	DesignLine Base Plate - Steel
A22	409mmL - DesignLine Flat Horizontal - Standard
A23	DesignLine Base Plate - Steel
A24	409mmL - DesignLine Flat Horizontal - Standard
A25	575mmW x 1000mmH - Flat standard
A26	575mmW x 1000mmH - Flat standard
A27	575mmW x 1000mmH - Flat standard
A28	575mmW x 1000mmH - Flat standard
A29	1000mmH Interconnector - 90 Deg Round
A30	1000mmH Interconnector - 90 Deg Round
A31	413mmW x 1000mmH - Flat standard cabinet door
A32	1000mmH Interconnector - 90 Deg Round
A33	1000mmH Interconnector - 90 Deg Round
A34	413mmW x 1000mmH - Flat standard
B21	1000mmH Interconnector - 90 Deg Round
B22	413mmW x 1000mmH - Flat standard
B23	1000mmH Interconnector - 90 Deg Round
B24	575mmW x 1000mmH - Flat standard
B25	575mmW x 1000mmH - Flat standard
B26	1000mmH Interconnector - 90 Deg Round
B27	413mmW x 1000mmH - Flat standard
B28	1000mmH Interconnector - 90 Deg Round
B29	575mmW x 1000mmH - Flat standard
B30	575mmW x 1000mmH - Flat standard
C1	1000mmH Interconnector - 90 Deg Round
C2	413mmW x 1000mmH - Flat standard
C3	1000mmH Interconnector - 90 Deg Round
C4	575mmW x 1000mmH - Flat standard
C5	575mmW x 1000mmH - Flat standard
C6	1000mmH Interconnector - 90 Deg Round
C7	413mmW x 1000mmH - Flat standard
C8	1000mmH Interconnector - 90 Deg Round
C9	575mmW x 1000mmH - Flat standard
C10	575mmW x 1000mmH - Flat standard
D1	1000mmH Interconnector - 90 Deg Round
D2	413mmW x 1000mmH - Flat standard
D3	1000mmH Interconnector - 90 Deg Round
D4	575mmW x 1000mmH - Flat standard
D5	575mmW x 1000mmH - Flat standard
D6	1000mmH Interconnector - 90 Deg Round
D7	413mmW x 1000mmH - Flat standard
D8	1000mmH Interconnector - 90 Deg Round
D9	575mmW x 1000mmH - Flat standard
D10	575mmW x 1000mmH - Flat standard

Assembly Notes

- Step .1** Begin Assembly by fixing the Steel Base Plate to the underside of the of the 70mm extrusion**(A22 & A24)**. **(See Assembly Detail .1)**
- Step .2** Attach the platinum panel to the 70mm extrusion (A28). Place the channel on the rear of the panel into the connector on the extrusion and lock in position. **(See Assembly Detail .1)**
- Step .3** Assemble the panels starting with **(A29)**. Slide the panels together by following the numbering sequence ending with **(D9)**.

Assembly Detail .1



Plan View

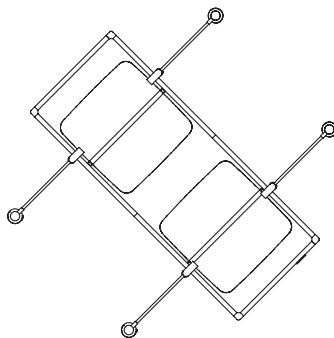

Assembly Instructions Notes -

Step .1 Locate Part **A35** in the packing cases and begin assembly from the starting point. Each of the components are individually numbered and has a drawing that explains it's location and installation.

Step .2 Follow the numbering sequence to complete **Area 3**.

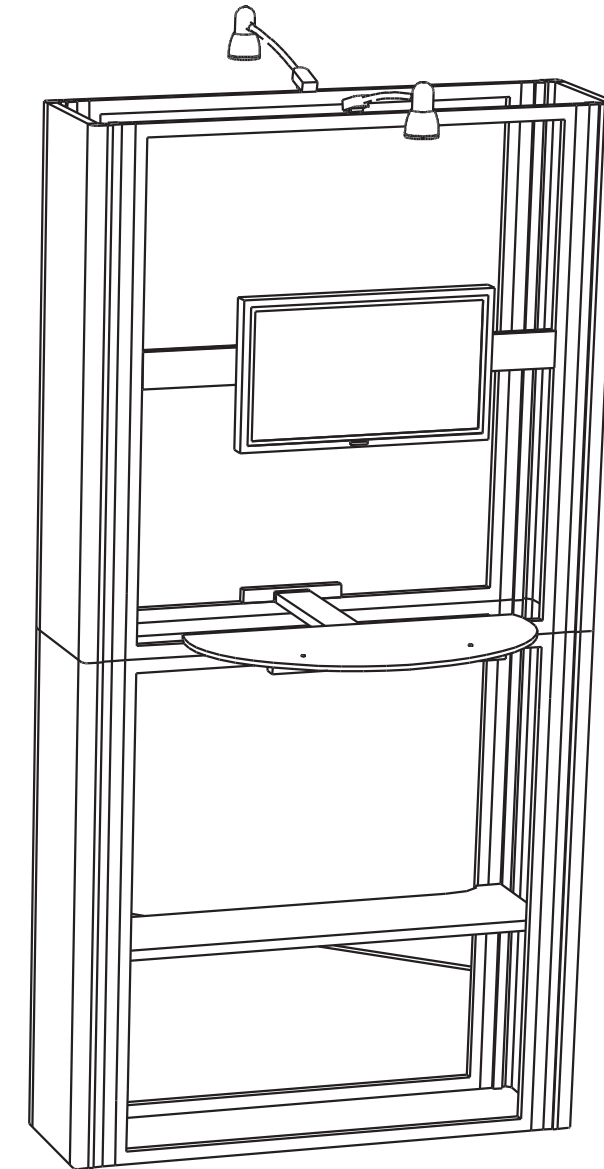

Area 3 - Perspective View

Area 3 - Plan View

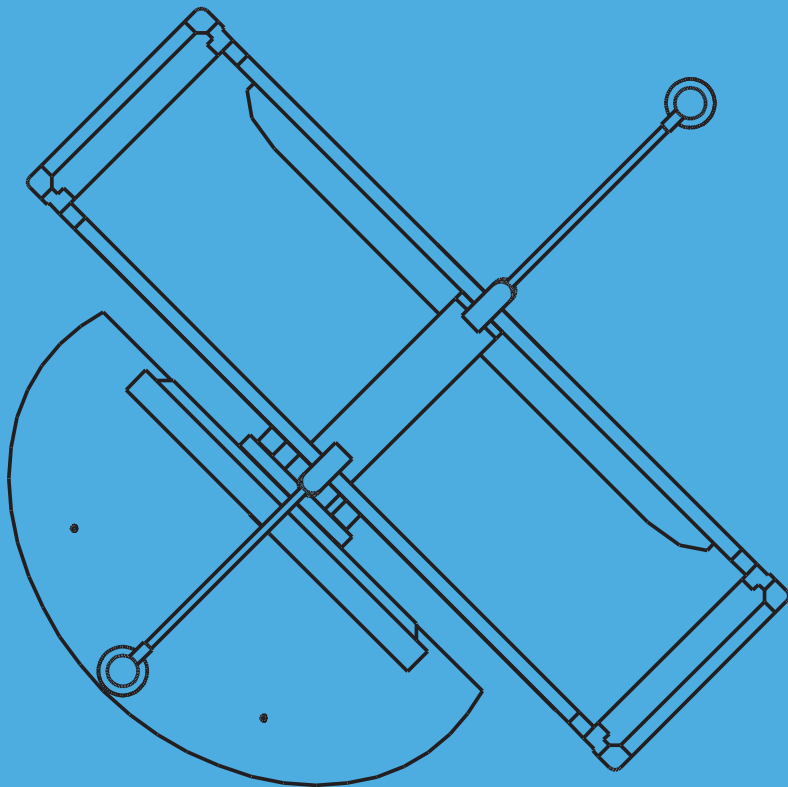

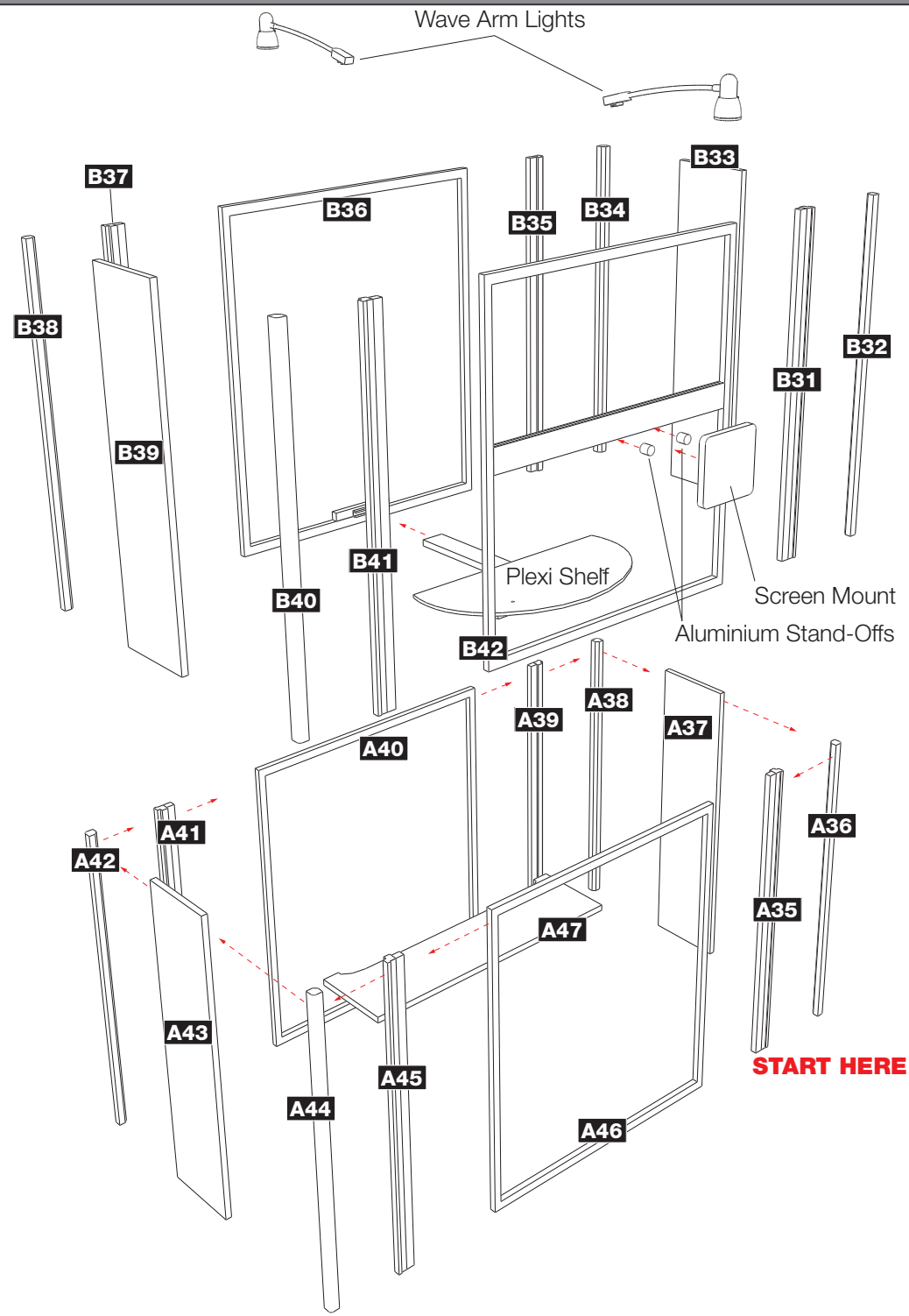

Part Description

A35	1000mmH Interconnector Platinum / Graphic with endcap
A36	1000mmH Interconnector - 90 Deg Round
A37	250mmW x 1000mmH - Flat standard
A38	1000mmH Interconnector - 90 Deg Round
A39	1000mmH Interconnector Platinum / Graphic with endcap
A40	830mmW x 1000mmH - Flat Bareframe
A41	1000mmH Interconnector Platinum / Graphic with endcap
A42	1000mmH Interconnector - 90 Deg Round
A43	250mmW x 1000mmH - Flat standard
A44	1000mmH Interconnector - 90 Deg Round
A45	1000mmH Interconnector Platinum / Graphic with endcap
A46	830mmW x 1000mmH - Flat Custom Bareframe
A47	Custom Internal Shelf
B31	1000mmH Interconnector Platinum / Graphic with endcap
B32	1000mmH Interconnector - 90 Deg Round
B33	250mmW x 1000mmH - Flat standard
B34	1000mmH Interconnector - 90 Deg Round
B35	1000mmH Interconnector Platinum / Graphic with endcap
B36	830mmW x 1000mmH - Flat Bareframe
B37	1000mmH Interconnector Platinum / Graphic with endcap
B38	1000mmH Interconnector - 90 Deg Round
B39	250mmW x 1000mmH - Flat standard
B40	1000mmH Interconnector - 90 Deg Round
B41	1000mmH Interconnector Platinum / Graphic with endcap
B42	830mmW x 1000mmH - Flat Custom Bareframe

Plan View

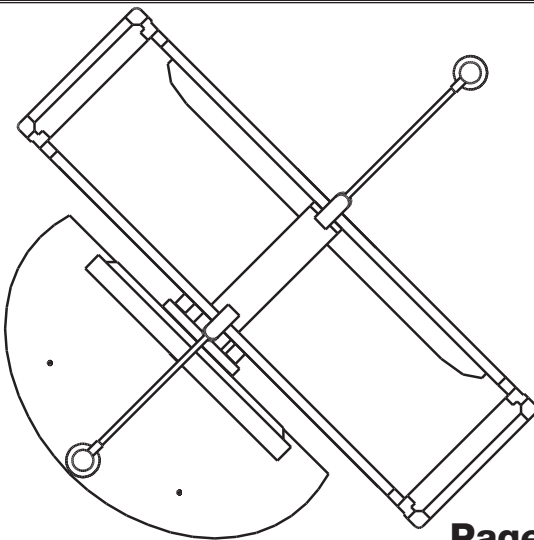

Assembly Notes

- Step .1** Assemble the panels starting with **(A35)**. Slide the panels together by following the numbering sequence ending with **(B42)**.
- Step .2** Attach the Shoulder Bolts into the threaded inserts midway on the 'A level' panels to support the Internal Shelf **(A47)**. The Shoulder bolts can be found in the Care Kit.

Assembly Detail .1



Fix panel **(A40)** to panel **(B36)** using clips on the panel

Assembly Detail .2



Insert the connector on the plexi shelf into the channel on (B35) and lock in position

Assembly Detail .3

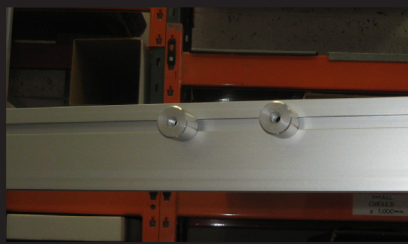

To attach screen mount insert stand-offs into the channel on panel (B42) then use the wing nut to attach the screen to the stand-offs

Assembly Instructions Notes -

Step .1 Locate Part **A48** in the packing cases and begin assembly from the starting point. Each of the components are individually numbered and has a drawing that explains it's location and installation.

Step .2 Follow the numbering sequence to complete **Area 4**.

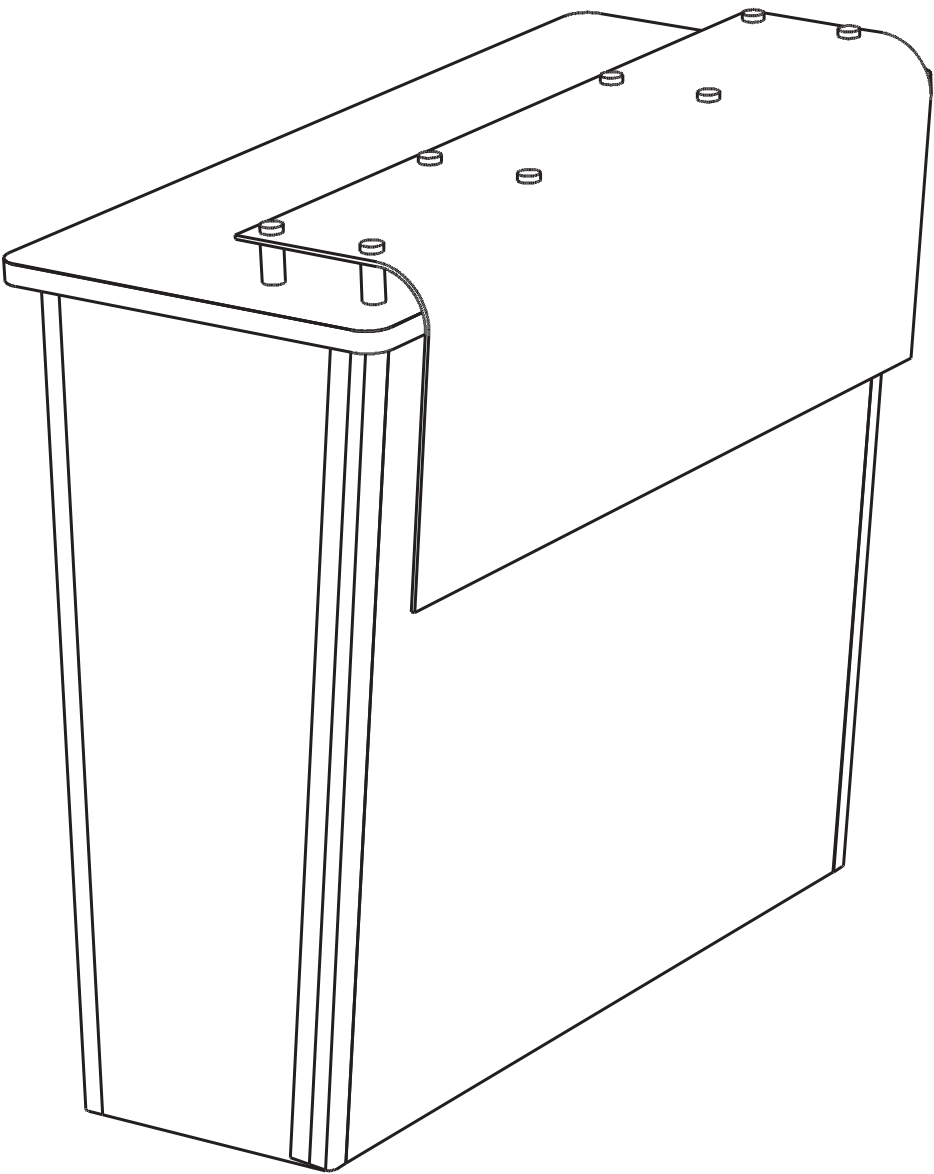

Area 4 - Perspective View

Area 4 - Plan View

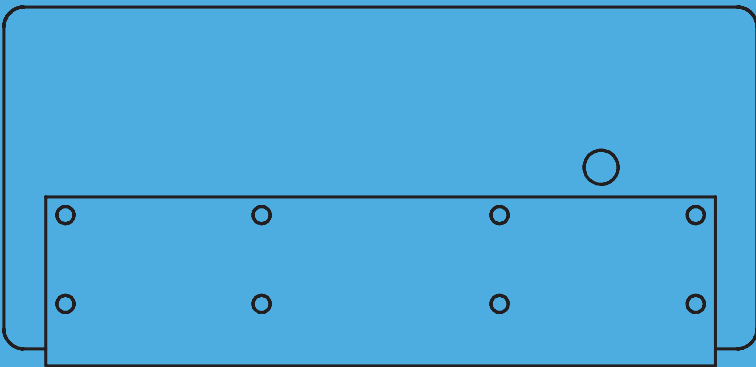

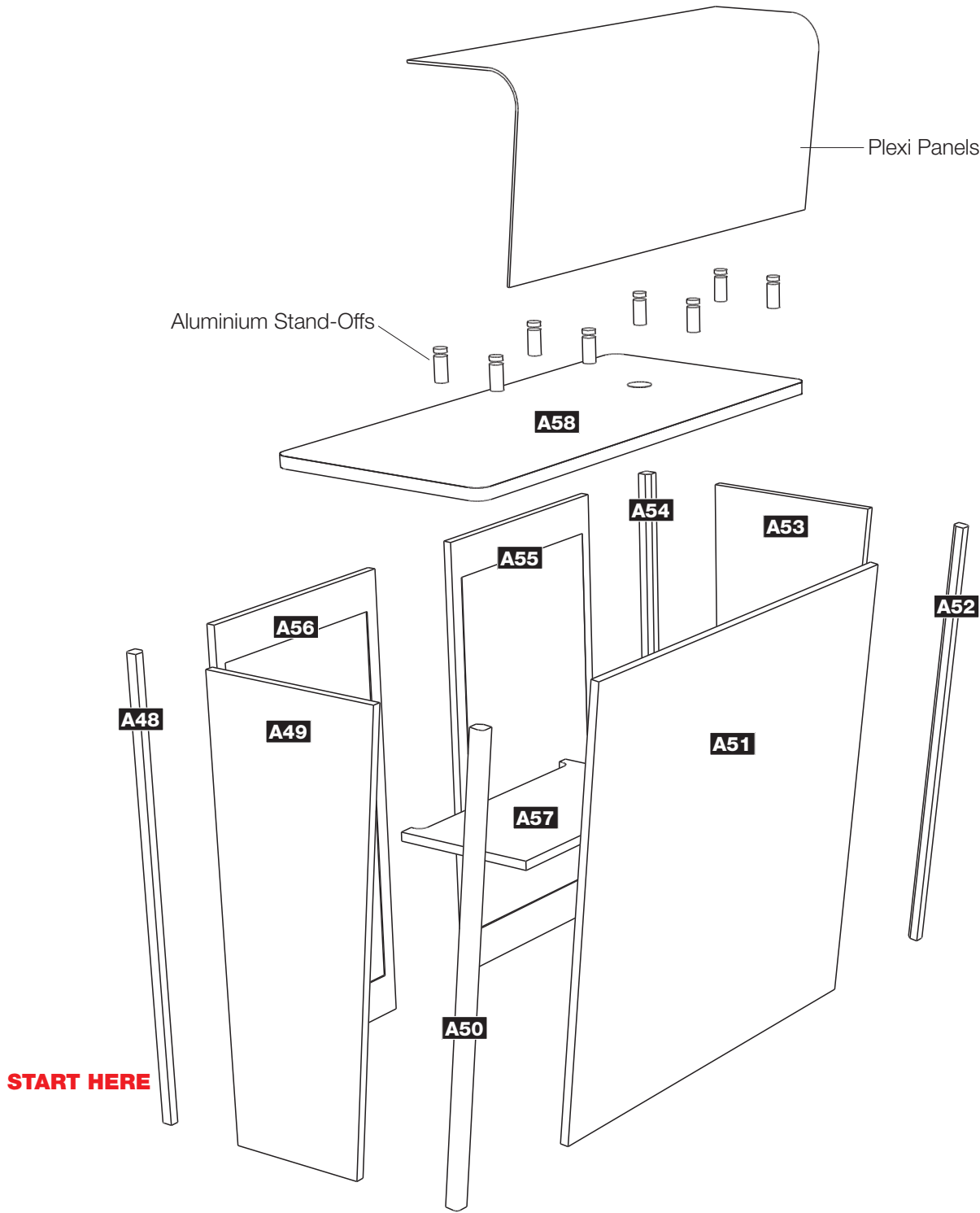

Part Description

A48	1000mmH Interconnector - 90 Deg Round
A49	413mmW x 1000mmH - Flat Custom with sq endcap
A50	1000mmH Interconnector - 90 Deg Round
A51	1000mmW x 1000mmH - Flat Custom
A52	1000mmH Interconnector - 90 Deg Round
A53	413mmW x 1000mmH - Flat Custom with sq endcap
A54	1000mmH Interconnector - 90 Deg Round
A55	500mmW x 1000mmH - Flat standard Cabinet Door
A56	500mmW x 1000mmH - Flat standard Cabinet Door
A57	Custom Internal Shelf
A58	Custom Counter Top

Plan View

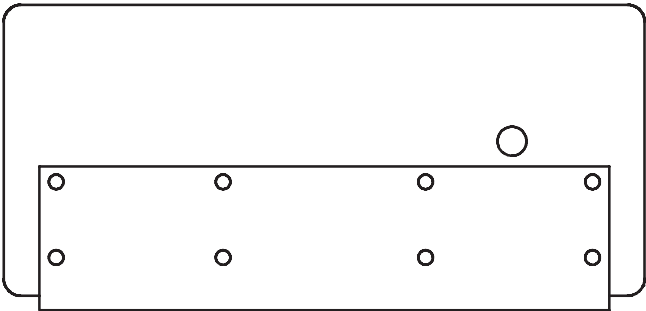

Assembly Notes

Assembly Detail .1

Assembly Detail .2

Assembly Detail .3

Step .1 Assemble the panels starting with **(A48)**. Slide the panels together by following the numbering sequence ending with **(A56)**.



Attach the Shoulder Bolts into the threaded inserts midway on the 'A level' panels to support the Internal Shelf **(A57)**.



Attach aluminium stand-offs to counter top. Place main body of stand-off on counter top surface and insert thumb screw from the bottom as shown.

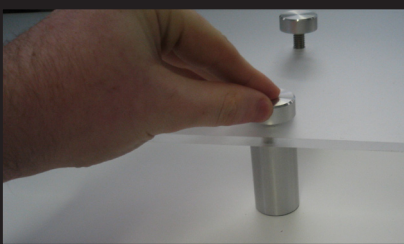

Attach the plexi to stand-offs as shown.